

ILFORD MULTIGRADE 500LE

ADAPTOR KIT FOR THE DE VERE 5108 ENLARGER

1

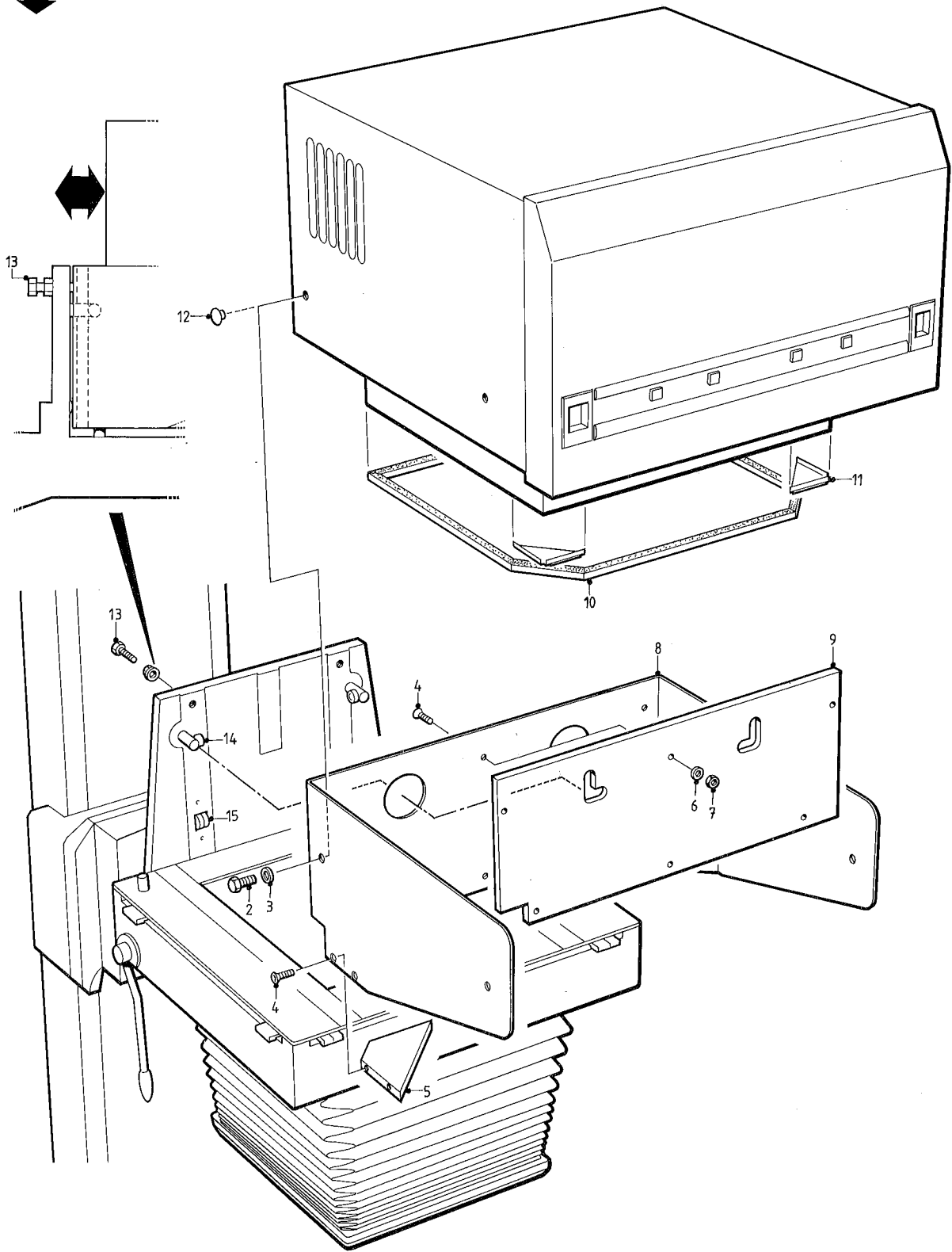

FITTING INSTRUCTIONS

Parts list

Ref no. on fig	Part no.	Description	Quantity
1	6184-P-006	Adaptor kit, complete	1
2	87989346	Screw, M6x10mm, hex hd	4
3	89730456	Washer, M6, plain	4
4	87990423	* Screw, M3x12mm, csk hd	14
5	6184-4-111	* Lifting plate	2
6	89730453	* Washer, M3, plain	6
7	86203903	* Nut, M3	6
8	6184-0-108	* Main frame	1
9	6184-2-110	* Back plate	1
10	89014029	Felt sealing strip	6ft
11	6184-P-007	Corner mask assembly	2
Other items			
12	-	Blanking plug	
13	-	Nylon screw	
14	-	Upper roller	
15	-	Lower roller	

Notes

- 1 Items marked * are supplied already assembled.
- 2 Items without part numbers are not included in the adaptor kit and are listed for identification only.

Notes for fitting

See figure.

WARNING

Never lean over counter balanced enlargers; failure of the locking mechanism could cause injury.

- 1 Remove the enlarger negative carrier.
- 2 Disconnect the original head from the electrical supply, and lift the head off the enlarger chassis.
- 3 Locate the two corner mask assemblies between the lower surface of the diffuser and the light mixing box shroud, as shown.

Note

To remove the diffusers, see the MULTIGRADE 500LE Operating manual, section 8.2. In this case, it is not necessary to remove the diffusers completely. The diffusers should be moved sufficiently to locate the corner mask assemblies.

- 4 Stick pieces of felt sealing strip to the bottom of the light mixing box shroud and the corner mask assemblies, as shown. The felt will form a light tight seal when the head is in position on the enlarger chassis.
- 5 Remove the four blanking plugs from the head. Secure the head to the adaptor main frame assembly with the four M6x10mm hexagonal head screws and washers, as shown.
- 6 On the enlarger chassis, back off the two lower rollers and the nylon screws. If necessary, refer to the manufacturer's instructions.
- 7 Present the enlarger head to the chassis, and secure the head by locating the upper two rollers (on the enlarger chassis) in the adaptor main frame L-shaped cut-outs. Allow the head to drop gently. Ensure both roller assemblies are engaged correctly, with the rollers positioned on the front face of the back plate.
- 8 Locate the negative carrier.
- 9 Slacken the M6 hexagonal head screws securing the enlarger head to the adaptor. Allow the head to sit on the negative carrier. Tighten the M6 screws.
- 10 Screw the lower two rollers in until the head is lifted parallel to the negative carrier, when the enlarger lifting lever is operated. Lock the rollers in this position.
- 11 Tighten the two nylon screws until they just touch the rear face of the adaptor assembly.