

50/60Hz

ILFORD

OPERATING INFORMATION

ILFOLAB 1250RC

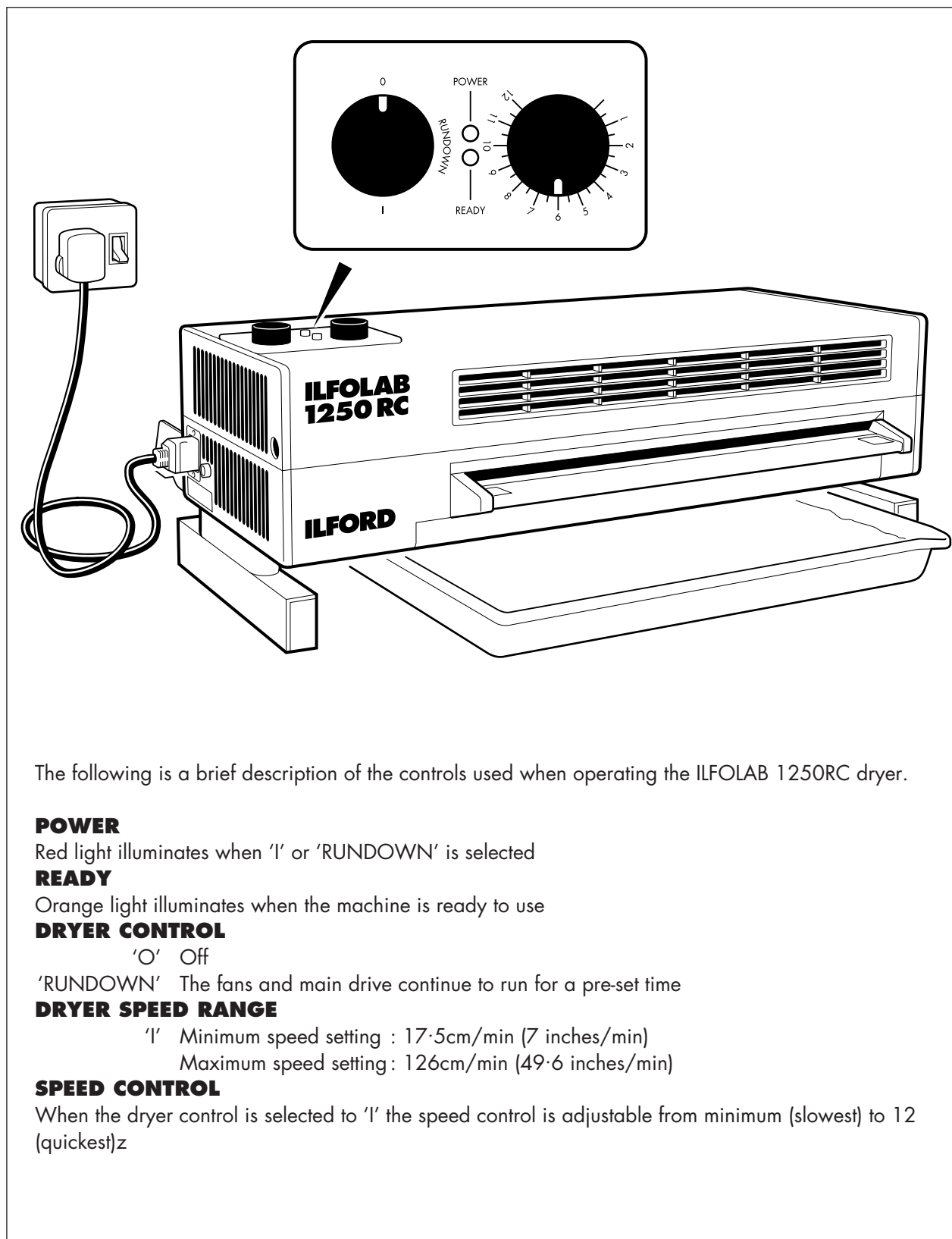

The following is a brief description of the controls used when operating the ILFOLAB 1250RC dryer.

POWER

Red light illuminates when '1' or 'RUNDOWN' is selected

READY

Orange light illuminates when the machine is ready to use

DRYER CONTROL

'0' Off

'RUNDOWN' The fans and main drive continue to run for a pre-set time

DRYER SPEED RANGE

'1' Minimum speed setting : 17.5cm/min (7 inches/min)

Maximum speed setting : 126cm/min (49.6 inches/min)

SPEED CONTROL

When the dryer control is selected to '1' the speed control is adjustable from minimum (slowest) to 12 (quickest)

INSTALLATION

Remove the yellow transit wedges from between the roller bearings on the four roller assembly. Secure the print receive tray as shown in Detail **B**. Position the dryer on a firm bench with space for adequate air circulation, see Detail **A**. Place the wet-print dish under the dryer.

- 1 Release button
- 2 Yellow transit wedges
- 3 Four-roller assembly
- 4 Restraining arm
- 5 Feed tray
- 6 Mains fuse
- 7 Electricity supply lead
- 8 Print receive tray
- 9 Pan head screw
- 10 Wet-print dish

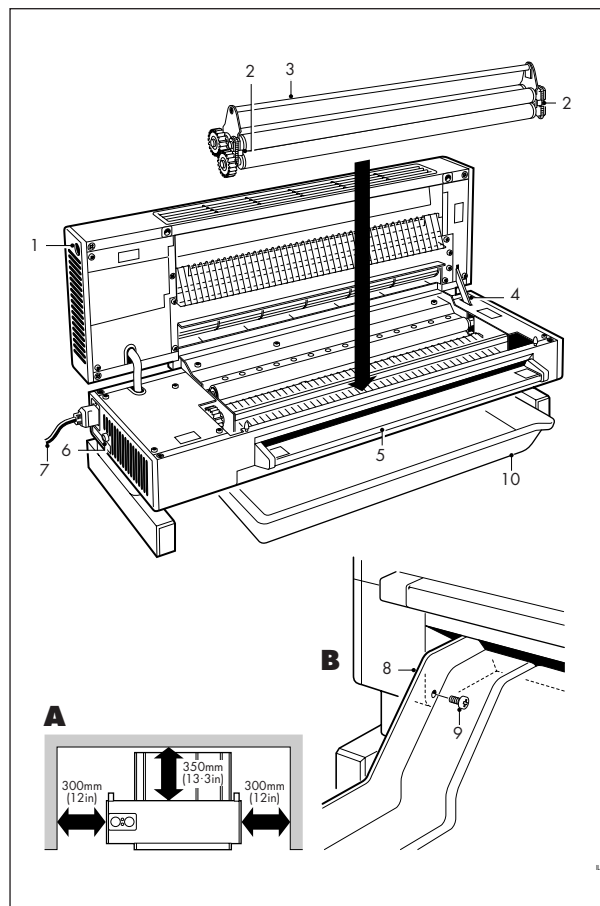

DRYING PRINTS

1 Fill the wet-print dish with enough cold water to cover the washed prints. Switch the electrical supply on. Turn the dryer control to 'I'. The red 'POWER' light illuminates.

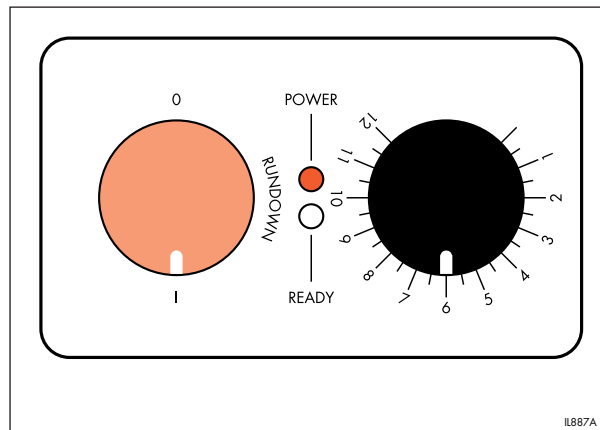

2 Allow about 1½ minutes for the orange 'READY' light to switch on. During this time, transfer the washed prints to the wet-print dish. As a guide, set the speed control to position 6 to dry resin coated paper sheets.

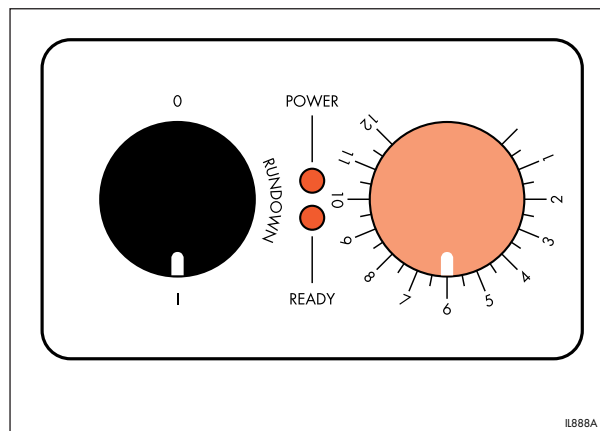

ILFORD

3 Feed prints emulsion side up. Ensure prints are fed squarely. Feed small prints with the short edge leading. Do not overlap one print with another - allow 2 seconds between the trailing edge of one print and the leading edge of the next.

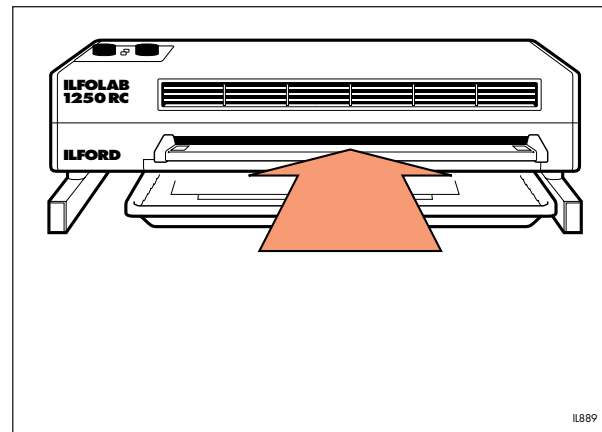

SWITCHING OFF

1 Turn the dryer control to 'RUNDOWN'. If the dryer is to be used again later in the same day, the control can be left in this position.

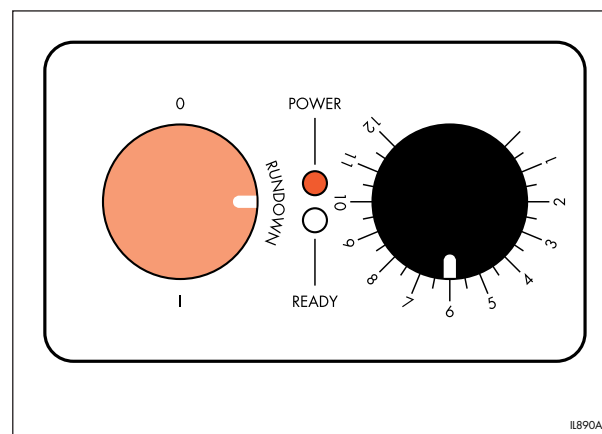

2 To switch the dryer off completely, select 'RUNDOWN' and wait for the fans and main drive to stop. Then turn the dryer control to '0'. Switch the electrical supply off.

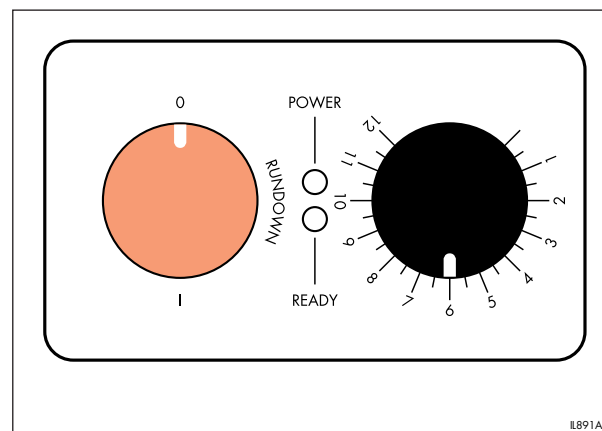

MAINTENANCE

Cleaning is the only regular maintenance required.



CAUTION

Do not allow water to enter areas of the dryer containing electrical components.

Daily routine

Change the water in the wet-print dish daily or more frequently if necessary.
Wipe the outside of the dryer with a damp cloth.

Cleaning the front roller assembly

Switch off the electrical supply. Open the dryer until the lid is held securely by the restraining arm. Lift the assembly away and clean with a soft lint free cloth and warm water. Refit the assembly and close the dryer.

REPLACING A MAINS FUSE



CAUTION

Switch off the mains supply to the dryer before starting this procedure.

Remove the fuse by turning the fuseholder anti-clockwise with a screwdriver. Replace the fuse with one of the correct value. Refit the fuse by turning the fuseholder clockwise with a screwdriver.

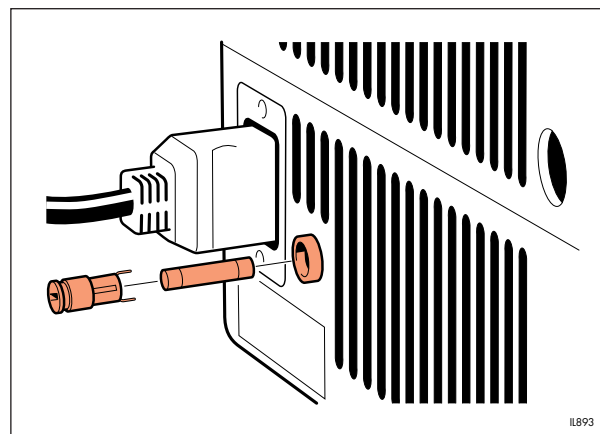

REPLACING A ROLLER TENSION SPRING

Switch the electrical supply off. Open the dryer lid until it is held securely by the restraining arm. Lift out the four-roller assembly. Replace the left hand side tension spring as shown in Detail **A**. Replace a right hand side tension spring as shown in Detail **B**. Refit the roller assembly and close the dryer.

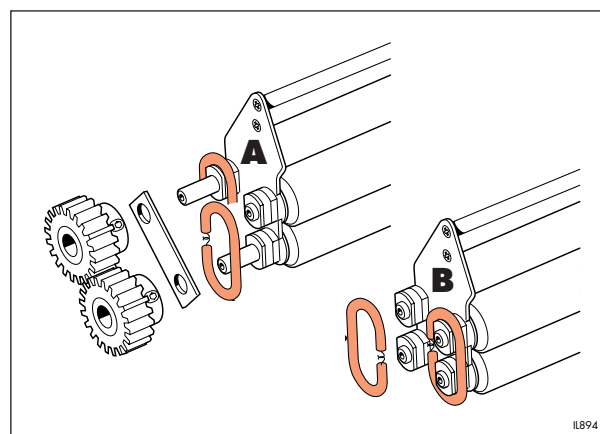

ADJUSTING PRINT EXIT GUIDE



CAUTION

Switch off the mains supply to the dryer before starting this procedure.

The print exit guide is factory set, under normal operating conditions it must not be moved. However, if a rear lower roller needs to be removed the print exit guide must be repositioned correctly. Check that the rear edge of the alignment mark on the print exit guide is aligned with the front edge of the ventilation grille as shown in Detail **A**.

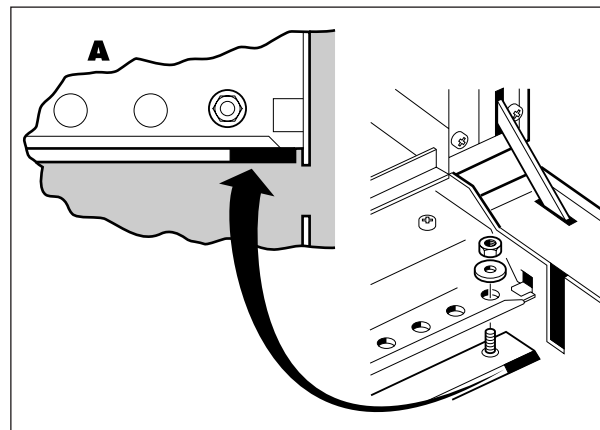

For further details contact: